

A Home Is A Home

Sylvain Gelewski

26.10–16.11.2024

The third part of The Court Jester project, the installation *A Home Is Home*, explores the notions of nomadic habitat, ancestral land, borders, dispossession, forced displacement, and reconstruction. It uses the location of the Peripherie 8 space, situated on the border between Basel-City and Basel-Land, as both a chromatic and geographical reference. The pieces bear stigmata reminiscent of gutted buildings and the landscape seen from above in a war zone. The installation focuses on the Palestinian enclave of Gaza, a zone, a land, and a home for millions of people. It serves as a philosophical and personal reflection on issues of responsibility, information, and involvement, examining what it means to have—or lack thereof—a home, or not, within one's own country.

How can we find objective and accurate information about the ongoing war if no international journalist is allowed to cover the conflict?

I won't forget the partisan machinations and political calculations, defying all common sense, humanity, and peace.

I won't forget all the "surgical strikes" by the IDF that tore apart buildings and dug ten-meter-deep holes in the ground.

I think of the Geneva Conventions, trampled on with each new incident.

Beni plays the situation like a deck of cards, making alliances with his knaves, turning laws and rules into his queens, thinking himself a king, always keeping an American ace up his sleeve, without even bothering to wear the joker's mask.

I think of all I want to say, and the only sentence that comes out in this moment: "Gaza, my heart bleeds when I think of you."

Missile launcher, human target, house of cards, rocket launcher, human shield, iron dome.

I think about slipping a watermelon into the thought bubble of a chat on Instagram instead of a comment.

I will not forget the equivalent of six Hiroshima bombs dropped on Gaza in one year.

I think of the numbers and reports every day. Human beings become statistics, existing only through their disappearance.

A land is a homeland.

A country is a house.

A territory is a refuge.

A home is a home.

Sylvain Gelewski is an artist and curator from Geneva (Switzerland). He is interested in lists, colours, political events, neurodivergence, and the value of work, through a play between norms and their most superfluous details. Recent solos: Sihl Delta, Zurich, CH (2024); Back Beat Bolaget, Sandviken, SE (2023); Dogo Residenz, Lichtensteig, CH (2021); E-Werk, Freiburg im Breisgau, DE (2020). Recent group shows: Kunsthalle Trier, DE; Gowen Contemporary, Geneva, CH (2024); Ausstellungsraum Klingental, Basel, CH; Raum für Sichtbarkeit, Berlin, DE (2023); Flux Laboratory, Geneva, CH; der TANK, Basel, CH (2022); Cité internationale des arts, Paris, FR (2021); Centre d'Art Contemporain, Geneva, CH; Fabienne Levy Gallery, Lausanne, CH; Centre d'Art Contemporain, Yverdon-les-Bains, CH (2020).

Opening October 26th 2024, 6 – 8 pm

Performance with María Sabato, 7 pm

Opening Times: Friday/Sunday, 3 – 5 pm or by appointment

Finissage November 16th 2024, 5 – 7 pm

The exhibition is supported by the Christian Merian Stiftung.

sylvaingelewski.com

[@syl_gelewski](https://www.instagram.com/syl_gelewski)

[Peripherie 8](#)

Holestrasse 8, 4054 Basel

[@peripherie8_offspace_basel](#)

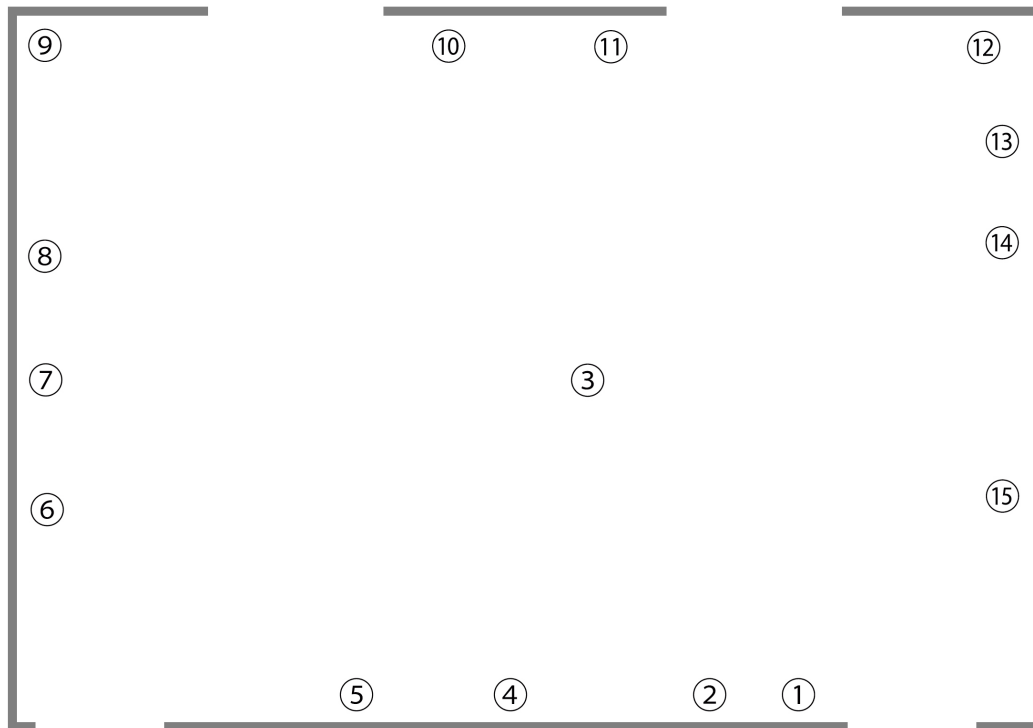

1. *Untitled (black & white)*, 27 x 21 x 1 cm, plaster, acrylic on found frame, 2023
2. *AHIAH (medium box)*, 40 x 31 x 7.5 cm, lacquer on scrap textile and canvas laminated on found wood box, plaster, 2024
3. *AHIAH (low table + lamp)*, 250 x 50 x 85 cm, lacquer, spray on scrap textile and canvas laminated on found antique table, metal, strings, plaster, collected broken porcelain and glass, coloured light, 2024
4. *The Court Jester 25 (Watermelon Resistance)*, 34 x 22 x 2.5 cm, oil, ink, marker on scrap linen canvas, lacquer on wooden frame, 2024
5. *Rafistolage 9*, 142 x 52 x 4 cm, oil on scrap canvas, cotton, jeans, strings, wood, 2023-2024
6. *The Court Jester 23 (Keffieh)*, 34 x 22 x 2.5 cm, oil, Indian ink, marker on scrap linen canvas, lacquer on wooden frame, 2024
7. *AHIAH (small box)*, 44 x 35 x 7.5 cm, lacquer on scrap textile and canvas laminated on found wood box, plaster, 2024
8. *The Court Jester 26 (Chimera)*, 34 x 22 x 2.5 cm, oil, marker on scrap linen canvas, lacquer on wooden frame, 2024
9. *AHIAH (chest + stick)*, 102 x 80 x 50 cm, lacquer on scrap textile and canvas laminated on found antique chest, metal, wood, plaster, cotton, glass, 2024
10. *Untitled (white)*, 25.5 x 19 x 1.5 cm, plaster, lacquer, acrylic on found frame, 2023
11. *Untitled (black)*, 25.5 x 19 x 2 cm, plaster, lacquer, acrylic on found frame, 2023
12. *AHIAH (newspaper + mask)*, 45 x 45 x 116 cm, lacquer on scrap textile and canvas laminated on found antique newspaper rack, wood, resin, plaster, polyester, cotton, glass, 2024
13. *AHIAH (stripes)*, 32 x 40 x 20 cm, lacquer on scrap textile and canvas laminated on found wood box, plaster, 2024
14. *Untitled (white) 2*, 25 x 25 x 2 cm, plaster, lacquer on found frame, 2023
15. *The Court Jester 24 (Uncle)*, 34 x 22 x 2.5 cm, oil, Indian ink, marker on scrap linen canvas, lacquer on wooden frame, 2024